



WIN THE GAME  
OF LIFE!



A one-stop for every sport at your doorstep is no longer a faded dream. Live the life you have always dreamt of in Hippodrome with ease. We provide you novel yet exotic homes. Live in a place where you can feel fit and stay healthy.

DD Sports City is spanned across 250 cents exclusively for sports activities, it is the host to 125 cents of the beautiful DD Hippodrome. 2 & 3 BHK apartments ranging from 861 sq.ft. to 1017 sq.ft. make for perfect living spaces. Activate your active mode with us.

YOUR HOME.  
YOUR PRIDE!

Call: +91 99617 66888

[www.desaihomes.com](http://www.desaihomes.com)

RERA No.K-RERA/PRJ/TVM/088/2022





TYPICAL FLOOR PLAN | 1<sup>st</sup> to 19<sup>th</sup> Floor

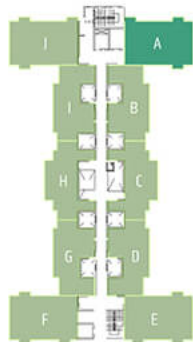
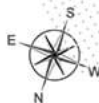

TYPE - A | 3 BHK | Super Built Up Area: 1008 Sq.Ft | 1<sup>st</sup> to 19<sup>th</sup> Floor

Area as per RERA (Including internal Walls & Toilet, excluding Balcony) - 650 Sq.Ft

Dimensions may vary slightly during construction. Furniture and fixtures are indicative only. All dimensions are in centimeters. Plots and areas are subject to minor changes.

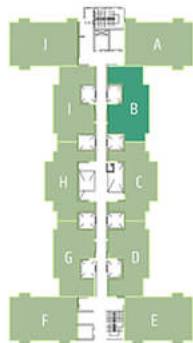

**TYPE - B | 2 BHK | Super Built Up Area: 901 Sq.Ft | 1<sup>st</sup> to 19<sup>th</sup> Floor**  
 Area as per RERA (Including internal Walls & Toilet, excluding Balcony) - 567 Sq.Ft

Dimensions may vary slightly during construction. Furniture and fixtures are indicative only. All dimensions are in centimeters. Plans and areas are subject to minor changes.

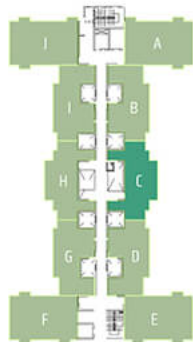
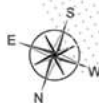

TYPE - C | 2 BHK | Super Built Up Area: 864 Sq.Ft | 1<sup>st</sup> to 19<sup>th</sup> Floor

Area as per RERA (Including internal Walls & Toilet, excluding Balcony) - 543 Sq.Ft

Dimensions may vary slightly during construction. Furniture and fixtures are indicative only. All dimensions are in centimeters. Plans and areas are subject to minor changes.

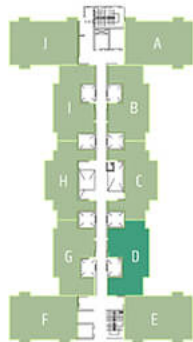
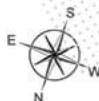

**TYPE - D | 2 BHK | Super Built Up Area: 896 Sq.Ft | 1<sup>st</sup> to 19<sup>th</sup> Floor**

Area as per RERA (Including internal Walls & Toilet, excluding Balcony) - 565 Sq.Ft

Dimensions may vary slightly during construction. Furniture and fixtures are indicative only. All dimensions are in centimeters. Plans and areas are subject to minor changes.

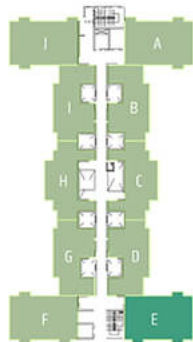
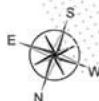

TYPE - E | 3 BHK | Super Built Up Area: 983 Sq.Ft | 1<sup>st</sup> to 19<sup>th</sup> Floor

Area as per RERA (Including internal Walls & Toilet, excluding Balcony) - 634 Sq.Ft

Dimensions may vary slightly during construction. Furniture and fixtures are indicative only. All dimensions are in centimeters. Plans and areas are subject to minor changes.



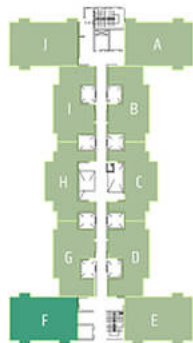

TYPE - F | 3 BHK | Super Built Up Area: 985 Sq.Ft | 1<sup>st</sup> to 19<sup>th</sup> Floor

Area as per RERA (Including internal Walls & Toilet, excluding Balcony) - 634 Sq.Ft

Dimensions may vary slightly during construction. Furniture and fixtures are indicative only. All dimensions are in centimeters. Plans and areas are subject to minor changes.

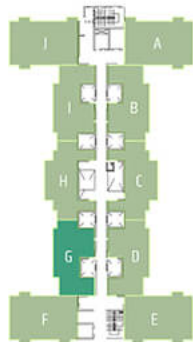
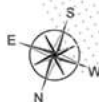

TYPE - G | 2 BHK | Super Built Up Area: 896 Sq.Ft | 1<sup>st</sup> to 19<sup>th</sup> Floor

Area as per RERA (Including internal Walls & Toilet, excluding Balcony) - 565 Sq.Ft

Dimensions may vary slightly during construction. Furniture and fixtures are indicative only. All dimensions are in centimeters. Plans and areas are subject to minor changes.

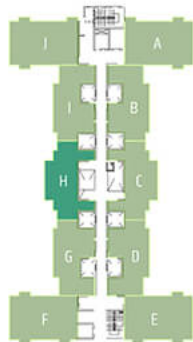
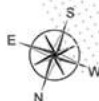

**TYPE - H | 2 BHK | Super Built Up Area: 861 Sq.Ft | 1<sup>st</sup> to 19<sup>th</sup> Floor**

Area as per RERA (Including internal Walls & Toilet, excluding Balcony) - 545 Sq.Ft

Dimensions may vary slightly during construction. Furniture and fixtures are indicative only. All dimensions are in centimeters. Plans and areas are subject to minor changes.

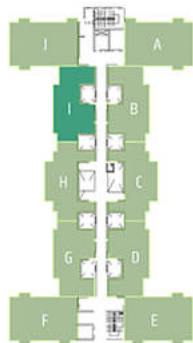
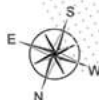

**TYPE - I | 2 BHK | Super Built Up Area: 897 Sq.Ft | 1<sup>st</sup> to 19<sup>th</sup> Floor**

Area as per RERA (Including internal Walls & Toilet, excluding Balcony) - 565 Sq.Ft

Dimensions may vary slightly during construction. Furniture and fixtures are indicative only. All dimensions are in centimeters. Plans and areas are subject to minor changes.

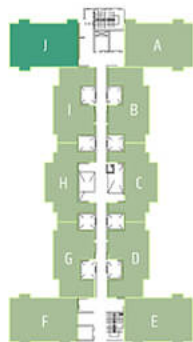
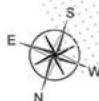
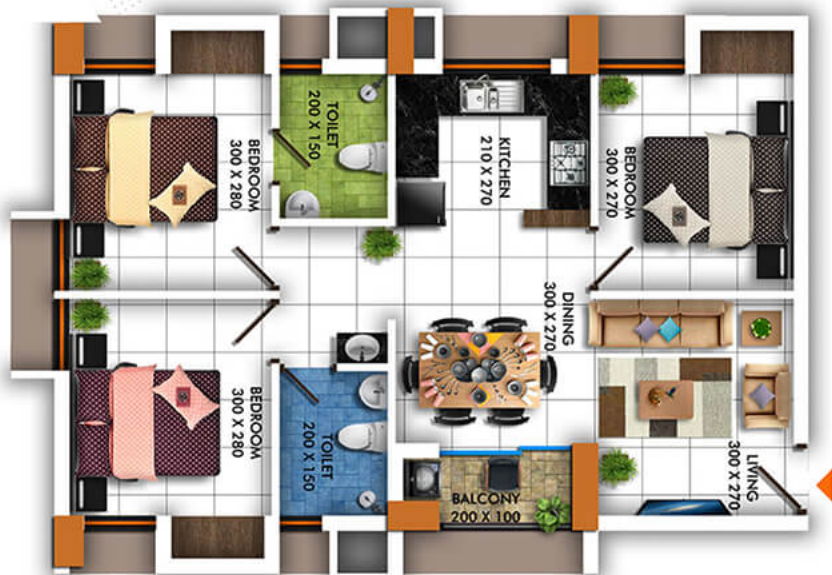

TYPE - J | 3 BHK | Super Built Up Area: 1017 Sq.Ft | 1<sup>st</sup> to 19<sup>th</sup> Floor

Area as per RERA (Including internal Walls & Toilet, excluding Balcony) - 650 Sq.Ft

Dimensions may vary slightly during construction. Furniture and fixtures are indicative only. All dimensions are in centimeters. Plans and areas are subject to minor changes.

## SPECIFICATIONS

- Flooring: Fully Vitrified tiles except toilet and balconies.
- Putty finished plastic emulsion painted walls in the entire apartment.
- Antiskid bathroom floor tiles with designer wall tiles upto ceiling.
- Good quality CP Fittings (Hindware or equivalent) and white coloured Sanitary Fittings (Cera or equivalent).
- Fire retardant (FR) cables (V Guard or equivalent), MCB's and ELCB. (L&T or equivalent).
- Modular Switches (Anchor, Panasonic or equivalent).



- Front door - Flush door fitted with Godrej or equivalent lock, inside paneled skin doors and powder coated Aluminium windows with Glass & Grill.
- 32 Amps A/C point - 1 point for 2 & 3 BHK flat (additional 32 Amps A/C points will be charged extra).
- 16 Amps plug point - 5 points per 3 BHK flat and 4 points per 2 BHK flat, including Geyser point in all toilets.
- Provision for Aqua Guard.
- Provision for Geysers and Exhaust Fan in all Toilets.

## AMENITIES

- Club House with Family Health Club, Sauna, Table Tennis, Billiards, Pool Table, Caroms, Chess and Separate Gym for ladies
- Swimming Pool (Olympic size)
- Ladies Pool and Kids Pool
- Football Court (Full size) 45 mtrs. x 90 mtrs.
- Basketball Court (Full size)
- Tennis Court - 2 Nos
- Indoor Shuttle Court - 4 Nos
- Jogging Track - 275 mtrs. long
- Children's Play Area with Equipments



- Provision for Cable TV connection with Internet Broadband (at extra cost)

- Elder's Corner
- Rain Water Harvesting
- Sewage Treatment Plant
- Centralized Gas Connection (at extra cost)
- Emergency Power Supply (at extra cost)
- Fire Fighting System
- 24 Hours Security
- 'A' Class Elevation



## PROXIMITY

Technocity, Pallippuram	3.50 Km
Nissan Digital Hub	2.50 Km
Proposed Light Metro	3.00 Km
Bio Life Science park, Thonnackal	4.00 Km
Kendriya Vidyalaya, Pallippuram	3.00 Km
Blue Mount Public School, Thonnackal	3.50 Km
Trivandrum International School	7.00 Km
Murukkumpuzha Railway Station	1.00 Km
Kaniyapuram Railway Station	3.00 Km
Sainik Shool, Pallippuram	8.00 Km
St.Thomas Institute for Science & Technology, Chandavila	11.00 km
Kaniyapuram KSRTC Bus Depot	3.50 Km
MGM School, Kazhakuttom	11.50 km
Technopark, Kazhakuttom	7.50 Km
Kazhakuttom Railway Station	8.00 Km
Taurus Zentrum Mall	8.00 Km
Infosys & UST Global	10.50 Km
Green Field Sports Hub	8.00 Km
Lulu Mall	13.00 Km
Trivandrum International Airport	17.00 Km
Mangalapuram Junction (NH)	2.50 Km





# Your HOME Your PRIDE!



## CONTACT US



TC-2/2408 (5), 3<sup>rd</sup> Floor, Asiatic Business Centre  
Near Nippon Toyota Showroom, By-pass Road, Kulathoor.P.O  
Kazhakuttom, Trivandrum, Kerala, India. Pin : 695 583  
Tel : +91 471 4000620, 4000720  
E-mail : [salestm@desaihomes.com](mailto:salestm@desaihomes.com)

**CALL : +91 96560 00882, 96560 00884**

### CORPORATE OFFICE

DD Trade Tower, 2<sup>nd</sup> Floor, Kaloor - Kadavanthra Road  
Ernakulam, Kerala, India. Pin : 682 017  
Tel : +91 484 4177888  
E-mail : [sales@desaihomes.com](mailto:sales@desaihomes.com)  
[www.desaihomes.com](http://www.desaihomes.com)

KOCHI | TRIVANDRUM | KOTTAYAM | THIRUVALLA | THRISSUR



Call: +91 99617 66888

[www.desaihomes.com](http://www.desaihomes.com)